

Career Opportunities In Tool & Die

Tool & Die Maker

Die Leader

Tryout Leader

CAD Die Designers

Design Leaders

CAD/CAM Programmer

CNC Machinists

CMM / Inspection

Program Manager

Supervision

Management



Die maker uses a DataMyte to input measurement data from a part on a check fixture.



Greenville Tool & Die Company, an employee owned company (ESOP), was established in 1946 and has grown to be a recognized industry leader in the design and building of high quality metal stamping dies. With a facility of more than 104,000 sq. ft. and a highly skilled workforce of 184, the company has learned to combine these attributes with today's technologies to competitively provide its customers with the highest quality and on time delivery.



Engineering Scholarship

See Your Counselor For A Scholarship Application or
Contact Human Resources at Greenville Tool & Die

P.O. Box 310, Greenville, MI 48838

Phone: 616 754-5693 Fax: 616 754-5500

See "Scholarship" on GTD Website: www.gtd.com



Engineering Scholarship



Renewable Scholarship

Full Tuition, Fees

& Book Allowance

Paid Work Experience

Pre-Engineering

*College Of Your
Choice*

*Application Deadline
April 9, 2010*

Engineering Scholarship



A paid work experience or internship is a very valuable on-the-job experience that helps students learn and mature in a professional working environment. It also provides the opportunity for the student to preview their chosen

career path from a perspective that cannot be learned in the classroom. Greenville Tool & Die has offered Co-op and nationally recognized Apprenticeship programs for more than 50 years. For qualifying students choosing a professional engineering career path, Greenville Tool & Die offers:

- ◆ Renewable engineering scholarship.
- ◆ Substantial tuition allowance.
- ◆ Text book allowance.
- ◆ Paid work experience.

At the completion of the work experience, the student will have:

- ◆ The option of transferring credits to pursue a 4-yr Engineering degree.
- ◆ Developed a strong work ethic.
- ◆ Potential full time employment and additional educational opportunities with Greenville Tool & Die.

Selection Criteria

- ◆ High School or College CGPA 3.25.
- ◆ Engineering Career Path.
- ◆ Letter(s) of Recommendation.
- ◆ Student Narrative.
- ◆ Availability To Start Work Experience After High School Graduation.
- ◆ Mutually Agreeable College of Choice Selection.

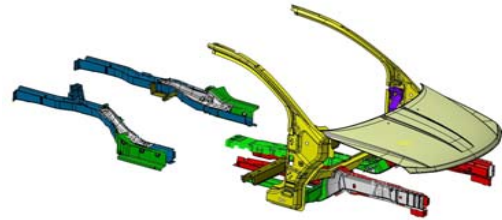

Automotive Parts Produced From Metal Stamping Dies.

HONDA
TOYOTA
NISSAN
FORD
DAIMLER-CHRYSLER
GM
BMW

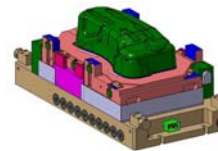
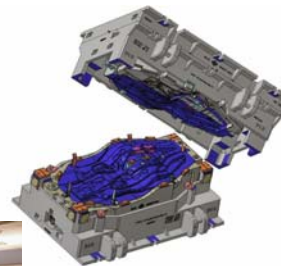

GREENVILLE TOOL & DIE

ENGINEERING SCHOLARSHIP

See Your Counselor For A Scholarship Application or Contact Human Resources at Greenville Tool & Die

P.O. Box 310, 1215 S. Lafayette, Greenville, MI 48838
Phone: 616-754-5693 Fax: 616 754-5500
See "Scholarship" on GTD Website: www.gtd.com

APPLICATION DEADLINE: APRIL 9, 2010